



LEVITON[®]

Home Safety
Solutions



It's easier than you think to make your home safer, and a good place to begin is with your electrical system. As a leading innovator of electrical safety for over 110 years, Leviton delivers safety products that help protect you, your family and your property, all while meeting or exceeding National Electrical Code® (NEC®) requirements and industry standards. This Guide will help you understand the products that are available and where and how they can be used.

Look for these symbols to ensure a safer environment:



AFCI Outlets - help detect potentially dangerous arc-faults in your electrical system, which can cause house fires



GFCI Outlets - protect residents from the dangers of shock or electrocution by tripping when a ground-fault is detected



Dual Function AFCI/GFCI Outlets - protect from electrical fires that could result from arc-faults and from electrical shock due to ground-faults



Tamper-Resistant (TR) Outlets
Provide protection against injury by helping to prevent foreign objects from being inserted into outlets

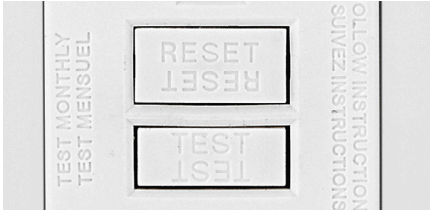

Patented Reset Lockout

As an additional safeguard, all Leviton AFCI, GFCI and AFCI/GFCI devices feature a reset/lockout function which prevents the device from being reset if any of the following conditions exist:

- GFCI or AFCI is not functioning properly
- GFCI or AFCI protection has been compromised
- Line and load wires were reversed during installation

Tamper-Resistant (TR) Outlets

Tamper-Resistant Outlets have a built-in shutter mechanism inside the receptacle that blocks access to the contacts from most foreign objects, allowing only a two- or three-prong plug to be inserted. Leviton Tamper-Resistant Outlets comply with the latest NEC requirements for tamper-resistant receptacles in residences and childcare facilities.

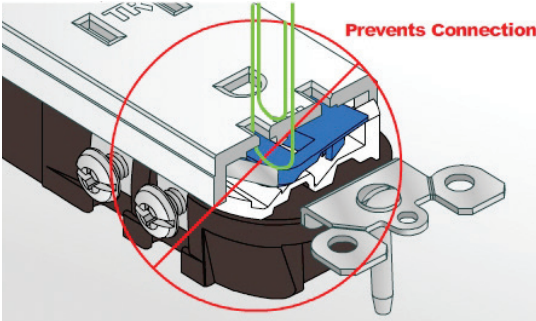



Preventing Electric Shock: Where you need GFCI protection

Required by the National Electrical Code (NEC) in many areas of the home, Ground-Fault Circuit Interrupter outlets are important safety devices that help protect people from electrical shocks due to hazardous ground-faults. GFCIs monitor the electrical power that is fed to anything plugged into the outlet. If a ground-fault is detected, it shuts off power to the item in a **fraction of a second**, to help prevent serious injury or death.

GFCI protection is required in:

- Bathrooms
- Garages and Accessory Buildings
- Outdoors/ Pools and Spas
- Basements
- Kitchens



GFCI with Guide Light



GFCI USB

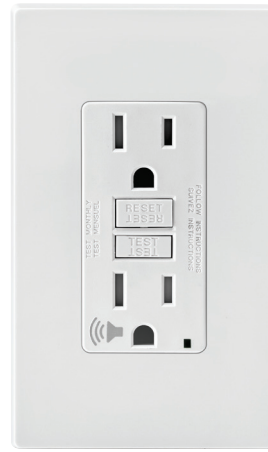

GFCI with
Audible Alert



Blank Face GFCI



Preventing Home Electrical Fires: Where you need AFCI Protection

Now required by the NEC in most living areas of the home, Arc-Fault Circuit Interrupter (AFCI) outlets are designed to help prevent electrical fires that can be caused by potentially dangerous arc-faults. An arc-fault is an unintentional arcing condition that occurs in an electrical circuit. Arcing can create high intensity heat which can ignite surrounding material such as wood framing or insulation. If the AFCI detects a hazardous arcing condition, it responds by interrupting electricity in that circuit.

AFCI protection is required in:

- Bedrooms
- Family rooms
- Dining rooms
- Rec rooms

Dual Function AFCI/GFCI protection is required in:

- Kitchen
- Laundry Room



AFCI Outlet



Combination with
Switch



Blank Face AFCI



Dual Function
AFCI/GFCI Outlet



Products that help create a safer living environment

Installing appropriate electrical devices in your home can help make it safer as you engage in everyday activities. We suggest the following solutions to improve overall safety for residents and visitors:



Tamper-Resistant Outlets – helps protect children from the dangers associated with inserting foreign objects, such as keys, into electrical outlets. A “must have” for all rooms where children are present.

Motion Sensors – hands-free convenience. Automatically turns lights ON and OFF when you step into or out of a room or space. Perfect for locations you may enter or exit with hands full, such as laundry rooms and garages.

Timers – program your lights to turn ON and OFF on schedule when you are not home to create a lived-in look, and to be certain you never come home to a dark house. Ideal for porch and outdoor lighting.



Guide Lights – provide a safe path in the dark. Perfect for hallways and staircases.

Illuminated Switches – makes it easy to locate a switch in a dark room. Use in basements, children’s rooms, bathrooms and guest rooms.



Tamper-Resistant
(TR) Outlets



Combo TR Outlet
and Guide Light



Motion Sensor



Illuminated Switch

MAKE IT SMART

Make your home a smart home by installing Decora Smart® switches, dimmers, fan speed controls, outlets and plug-ins for easy app-control of lighting when you are at home or away by using the free My Leviton app. We partner with the leading technologies to provide a solution for every home and user preference.

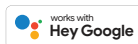



The Leviton Load Center

The Next Level of Safety

Are you having a new home built or renovating your existing home? Consider upgrading your load center to the award-winning Leviton Load Center. Enjoy safety features that exceed the UL Standard, a sleek new design, and intuitive LED diagnostics.

Superior GFCI/AFCI Protection

As the only GFCI circuit breakers on the market that exceed UL requirements, Leviton GFCIs create a new standard for home safety.

Leviton GFCI, AFCI and Dual Function circuit breakers feature our patented reset lockout and will not reset if ground- or arc-fault protection is compromised.

MAKE IT SMART

Homeowners who choose Smart Circuit Breakers can connect to the My Leviton app and enjoy easy access to their load center's data via a smartphone, tablet or desktop. View real-time energy consumption and calculate cost, trip a smart circuit breaker remotely, know when and why a breaker tripped, and so much more.





The Leviton Load Center



Single App Control with

An industry first, the My Leviton app consolidates control of the Leviton Load Center's smart circuit breakers and the Decora Smart® Wi-Fi® product lines, enabling users to seamlessly control load center activities and home lighting from anywhere in the world using their smartphone or tablet.

Available for download at



Leviton Manufacturing Co., Inc.

Tech Line: 1-800-824-3005

Mon-Fri 8am-10pm EST, Saturday 9am-7pm EST

For 24/7 product support visit www.leviton.com/support

Visit our Website at: www.leviton.com/safety

© 2021 Leviton Manufacturing Co., Inc. All rights reserved.
All trademarks are the property of their respective owners.

